

REVISIONS						
ECO NO	ZONE	REV.	DESCRIPTION	DATE	CHANGED BY	APPROVED
-	-	A	PRODUCTION RELEASE	5/17/16	-	RWH

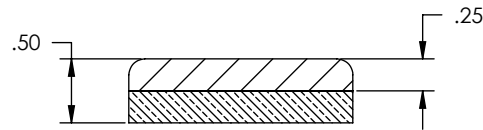
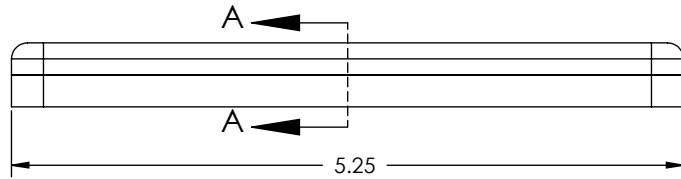
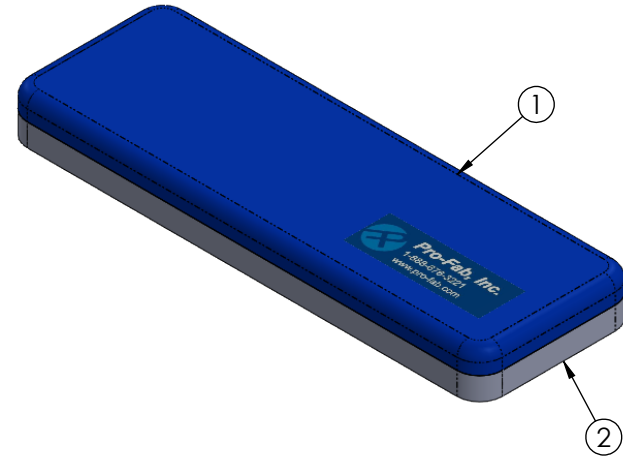
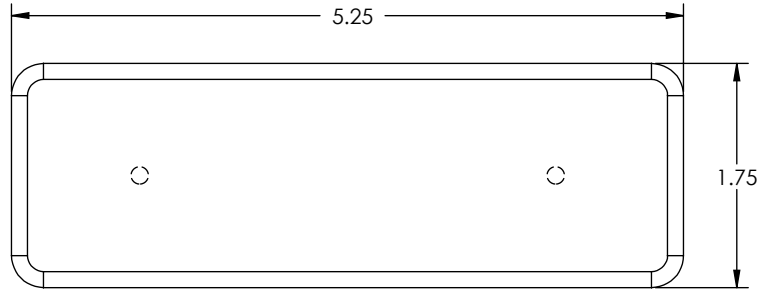

**SECTION A-A
SCALE 1 : 1.5**

ITEM NO.	PART NUMBER	QPA	VENDOR	DESCRIPTION	MATERIAL
1	75082A02-1	1	CREATIVE FOAM	1.75" x 5.25" WRIST PAD	1/4" CLOSED CELL FOAM
2	75082A02-2	1	PRO-FAB	PAD BASE	1/4" PVC

- GENERAL NOTES:**
 1. REMOVE BURRS AND BREAK SHARP EDGES.
 2. DIMENSIONS SHOWN IN PARENTHESIS () ARE REFERENCE ONLY ASME Y14.5M-1994 1.3.10
 3. ALL DIMENSIONS AND TOLERANCES ARE IN INCHES.
 4. DIMENSIONAL TOLERANCES AND SYMBOLS IN ACCORDANCE WITH ASME Y14.5M-1994
 5. USE LOCKTITE ON FASTENERS WITHOUT LOCKING DEVICES, AND KRYTOX ON NON-PERMANENT, REMOVABLE FASTENERS.
 6. 100% FUSE WELD UNLESS OTHERWISE SPECIFIED.

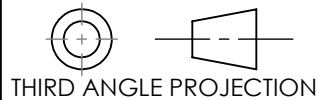

DIMENSIONS ARE IN INCHES UNLESS OTHERWISE SPECIFIED
 .X = ± .060 WELDMENTS = .030
 .XX = ± .030 CUTS = ± .030
 .XXX = ± .010 HOLE Ø = ± .005
 .XXXX = ± .005 ANGLES = ± .5°

	NAME	DATE
DESIGN	TAPLEY	10-8-08
DRAWN	RWH	5/17/16
SIZE:		
MATERIAL:		
FINISH: N/A		
VENDOR: PRO-FAB		
VENDOR P/N:		

PRO-FAB Inc.
 1040 BOSQUE FARMS BLVD-BOSQUE FARMS, NM 87068
 VOICE (505) 869-2222
 FAX (505) 869-3333
 www.pro-fab.com

TITLE: 1.75 X 5.25 WRIST REST	
SIZE A	DWG. NO. 75082A02
SCALE: NTS	WEIGHT: LBS
SHEET 1 OF 1	
REV A	

PROPRIETARY AND CONFIDENTIAL

THE INFORMATION CONTAINED IN THIS DRAWING IS THE SOLE PROPERTY OF PRO-FAB, INC. ANY REPRODUCTION IN PART OR AS A WHOLE WITHOUT WRITTEN PERMISSION OF PRO-FAB, INC. IS PROHIBITED.

DO NOT SCALE DRAWING